

# Volta

- |      |                          |      |                         |
|------|--------------------------|------|-------------------------|
| (DE) | Montageanleitung         | (HR) | Upute za montažu        |
| (FR) | Notice d'instructions    | (HU) | Szerelési útmutató      |
| (GB) | Mounting instructions    | (LT) | Montavimo instrukcija   |
| (NL) | Montage instructie       | (LV) | Montāžas instrukcija    |
| (DK) | Monteringsvejledning     | (PL) | Instrukcja montażowa    |
| (FI) | Asennusohje              | (RO) | Instructiuni de montare |
| (NO) | Montasjeanvisning        | (SK) | Návod na montáž         |
| (SE) | Monterings instruktioner | (RU) | Инструкция по монтажу   |
| (IT) | Istruzioni di montaggio  | (BG) | Инструкции за монтаж    |
| (ES) | Instrucciones de montaje | (GR) | Οδηγίες χώνευσης        |
| (PT) | Instruções de montagem   | (SI) | Navodilo za montažo     |
| (CZ) | Montážní návod           | (EE) | Paigaldusjuhised        |
| (BA) | Uputstvo za montažu      | (IS) | Leiðbeiningar           |

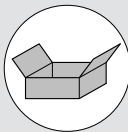
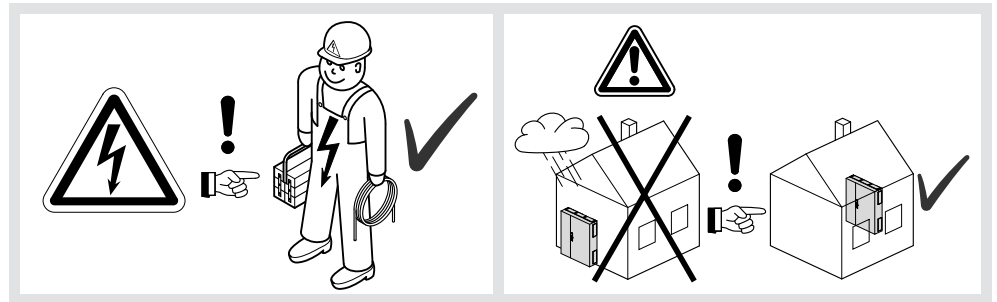

VZ455N

1x

